

ZhuZhu AQUARIUM

AGE GRADE 4+

This package includes:



4 CONNECTORS

1 RAMP



10 CORAL PIECES

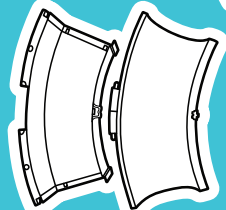

2 TURNS (TWO PARTS EACH)

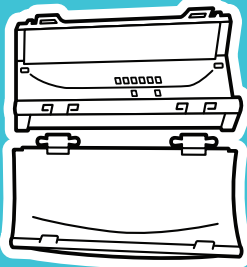

2 TUNNELS (TWO PARTS EACH)

1 Y-JUNCTION (TWO PARTS)

1

Unpacking your Zhu Zhu Aquarium™ Coral Reef Tunnel Combo Set

Remove all contents from package and discard any rubber bands, wire ties, or other packaging materials that are not part of the product.

Please Note

- Retain these instructions as they contain important information.
- Read all of the instructions before assembling your Coral Reef Tunnel Combo Set.
- Some adult assembly is required.
- The Zhu Zhu Aquarium™ Coral Reef Tunnel Combo Set is a toy. It is not intended for use with live animals or in water.

The Coral Reef Tunnel Combo Set is made to be used with Zhu Zhu Aquarium™ Fish which are sold separately. The Coral Reef Tunnel Combo Set works best on a smooth and open floor.

For more information on the Zhu Zhu Aquarium™ and other aquarium add-on sets and accessories please go to:

www.zhuzhuaquarium.com

2

Assembling the Zhu Zhu Aquarium™ Coral Reef Tunnel Combo Set

To maximize your Zhu Zhu Aquarium™ Fish's interaction with the playset, always use the tunnel marked "TO REEF →" as the entrance.

NOTE: Fish will not make noises or perform actions specific to playset unless it enters through this tunnel in the direction of the arrow.

- Attach the Ramp to the opening of the Tunnel **before** the engraved message: **TO REEF →**. Start at the top and snap the Ramp down into place.

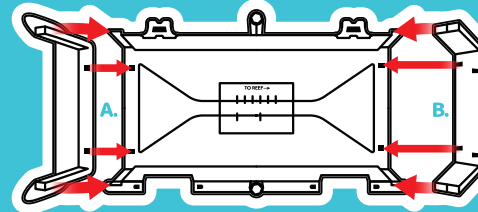

- Attach the Connector to the opening of the Tunnel **after** the engraved message: **TO REEF →**. Start at the top and snap the Connector down into place.

3

- Similarly, attach the Y-Junction, Turn, or Tunnel to the open side of the Connector by starting at the top and snap the Junction down into place.

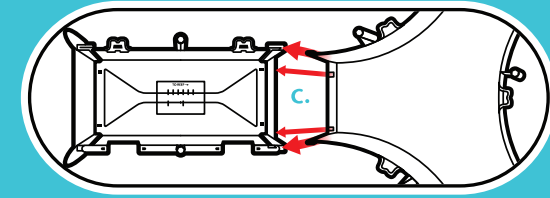

- To attach a Tunnel top to a Tunnel base, press one post on a Tunnel top into the hinge notch on a matching Tunnel base. Snap in the other post.

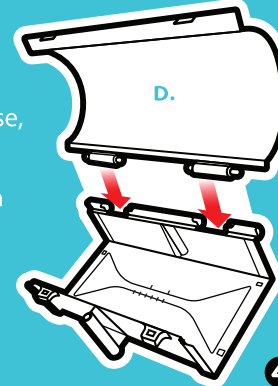

4

• **FISH SOLD SEPARATELY!**

- **DO NOT PUT FISH IN WATER!**
- **KEEP HAIR AWAY FROM WHEELS!**

For Questions and Comments please call: 1-800-225-9319

©2023 Cepia LLC.
St. Louis, Missouri 63124
Made in China

WARNING:
CHOKING HAZARD - Small parts
Not for Children Under 3 Years



Complies with
Toy Safety
Standard
ASTM F963

WARNING:

All rubber bands and wire ties, as well as tags, are not parts of this toy and should be discarded for your child's safety. Colors and contents may vary from those shown on the package.

Printed in China
REV T12102009 86650

8

- Close the Tunnel top, noting how the other side of the top snaps into place.

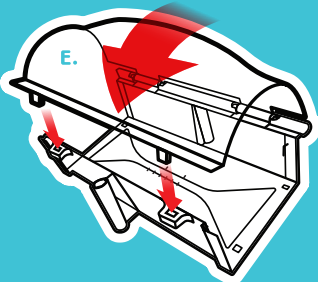

- Tunnel top closes as indicated in step "E."

- To attach Y-Junction top, align the 3 hooks of Top with the 3 hoops of the Base and snap into place.

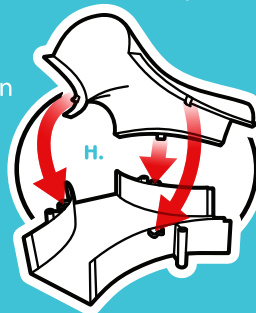

Assembling Turns as an S-Curve:

By reversing one of the Turns and using a Connector, you can create an S-Curve track.

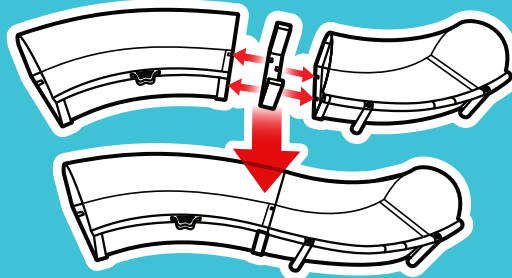

6

Assembling Turns as an S-Curve Continued:

The S-Curve can be attached to other add-on sets - which are sold separately.

Disassembly

To remove a Connector, gently pull apart from the bottom.

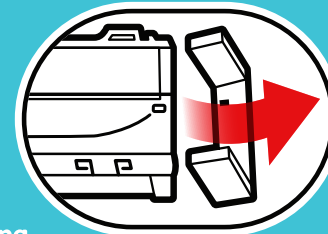

Troubleshooting

- Designed to act randomly and unpredictably, Fish may not act the same each time.
- If Fish gets stuck entering the Coral Reef, check all the snaps and Connector junctions.
- Fish works best on smooth, hard, and even surfaces. It will not work in water, carpet, or other soft surfaces. Do not use in sand or grass.
- The Coral Reef Tunnel Combo Set also works best on smooth, hard, and even surfaces.

7

5

- To attach a top to a Turn, press the center post on the Tunnel top into the hinge notch on the matching Turn base. Snap in post.

